

All Star Infiniti

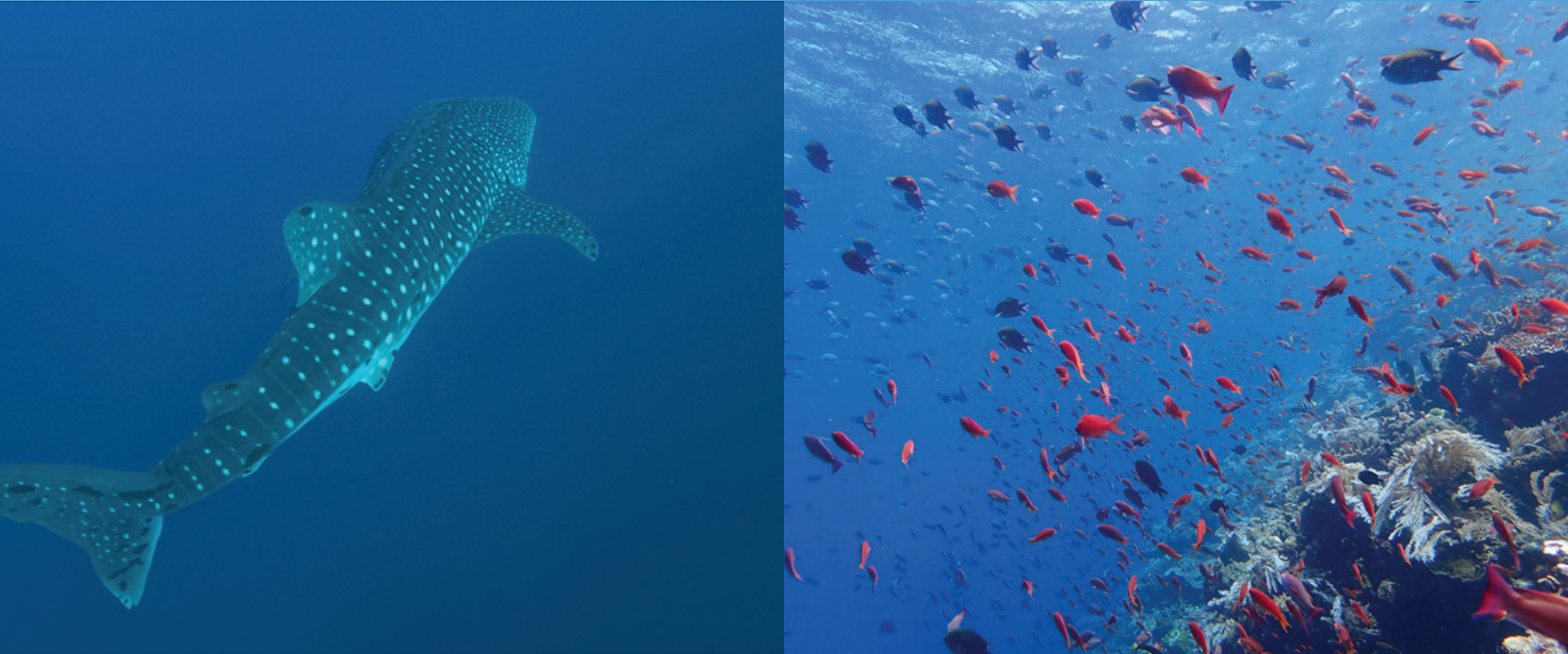

Dive World-Renowned Coral Triangle

- Reefs built by 574 species of coral
- Home to 1,400 types of fish and pelagics
 - whale sharks, manta rays, thresher sharks
- Astounding macro life and muck diving
- 6 night itineraries to:
 - Tubbataha in the Sulu Sea
 - Visayas and Bohol
 - Malapascua and Leyte
- 4 dives per day



TRIP DETAILS:



The Philippines

The Philippines is an archipelago comprised of 7,100 islands scattered over 500 miles in Southeast Asia. The islands are touched by four seas: the Philippine Sea, Celebes Sea, Sulu Sea and South China Sea. Dive highlights include Tubbataha Reef National Park, Apo Island Marine Reserve and nutrient-rich waters that attract pelagics to macro-critters and support abundant healthy hard and soft corals.

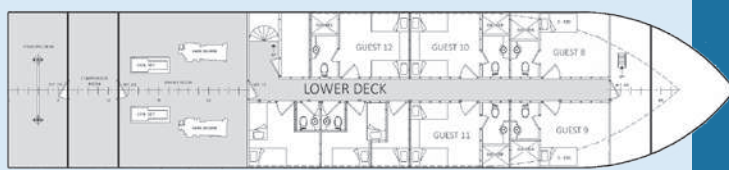
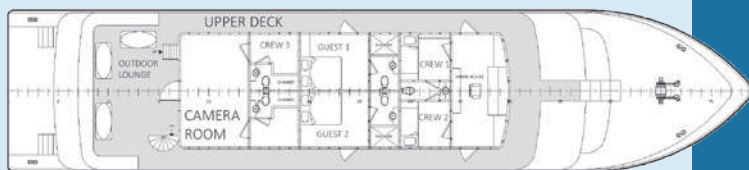

The Vessel

- 11 newly renovated cabins with en-suite bathrooms; accommodates 25 people
- Top deck with lounges and hammocks with sun and shade options or stargazing
- The upper deck with more places to relax
- Main deck - salon with living and dining areas, a bar, a large TV and entertainment library
- New spacious camera room, charging stations
- Includes all meals, snacks, drinks (including alcohol) and diving
- Departs from: Puerto Princesa or Cebu City
- 133-ft. long, steel hull vessel; only RINA-certified dive liveaboard in the Philippines: state-of-the-art navigation, communication and emergency management systems and equipment, firefighting appliances and CO-2 room